

产品特性 Features:

- ◇ 25A触点切换能力
25A switching capability
- ◇ 具有多种安装位置
Has a variety of mounting positions
- ◇ 具有多种接线方式
With a variety of wiring
- ◇ 防尘罩型封装结构
Dust cover type packaging structure
- ◇ 双开断触点
Double break contact

认证/标准 Standards/Approvals:

- ◇ UL-E246810
- ◇ CE
- ◇ REACH
- ◇ RoHS



产品型号规格 Product model and specification

型号规格 Item ID	额定电压 (VAC) Rated voltage	动作电压 (VAC) Pick-Up	释放电压 (VAC) Drop Out	线圈电阻 (Ω) Coil resistance	接触电阻 (mΩ) Contact resistance	触点形式 Contact form
PR360	24	≤20.4	≥4.8	90×(1±10%)	≤50	SPST-NO
PR362	120	≤102.0	≥24	2000×(1±10%)	≤50	SPST-NO
PR364	240	≤204.0	≥48	7200×(1±10%)	≤50	SPST-NO
PR366	277	≤235	≥55.7	11000×(1±10%)	≤50	SPST-NO
PR370	24	≤20.4	≥4.8	90×(1±10%)	≤50	SPDT
PR372	120	≤102.0	≥24	2000×(1±10%)	≤50	SPDT
PR374	240	≤204.0	≥48	7200×(1±10%)	≤50	SPDT
PR376	277	≤235	≥55.7	11000×(1±10%)	≤50	SPDT
PR380	24	≤20.4	≥4.8	90×(1±10%)	≤50	SPST NO+NC
PR382	120	≤102.0	≥24	2000×(1±10%)	≤50	SPST NO+NC
PR384	240	≤204.0	≥48	7200×(1±10%)	≤50	SPST NO+NC

外形图 Outline drawing

单位 unit: mm

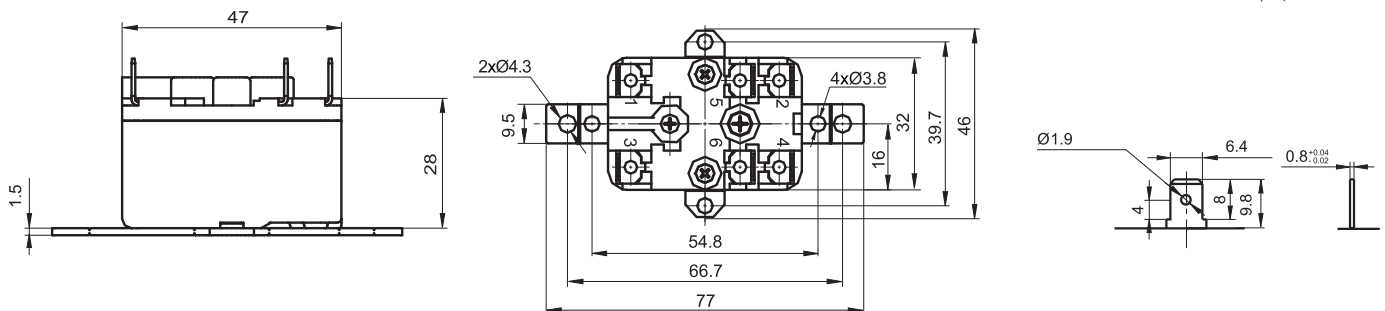

接线图 Wiring diagram

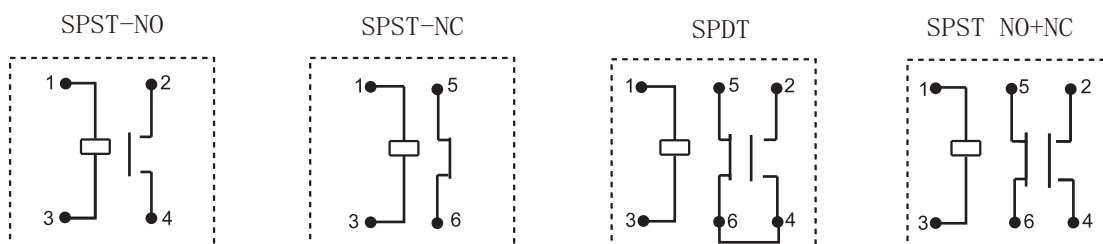

性能参数 Product Characteristics

触点形式 Contact form	1组常开/1组转换/1组转换+常开+常闭 SPST-NO/SPDT/SPST NO+NC	
接触电阻 Contact resistance	≤50mΩ (@6V/1A)	
触点材料 Contact material	AgCdO	
额定负载 Rated load	18A 277VAC(只分断) 18A 277VAC (breaking only)	
最大切换电压 Maximum commutation voltage	277VAC	
最大切换电流 Maximum commutation current	25A	
最大切换功率 Maximum switching power	4000VA	
机械耐久性 Mechanical durability	1X10 ⁶ 次	
电耐久性 Electrical durability	5X10 ⁴ (25A 277VAC, 阻性负载, 65℃, 1s通9s断) (25A 277VAC, resistive load, 65℃, 1s on and 9s off) 3X10 ⁴ (3A 277VAC, 通用负载, 65℃, 1s通9s断) (3A 277VAC, general load, 65℃, 1s on and 9s off)	
绝缘电阻 Insulation resistance	500MΩ (500VDC)	
介质耐压 Dielectric Strength	线圈与触点间 Between coil and contact	2500VAC 1min
	断开触点间 Between disconnecting contacts	1000VAC 1min
动作时间 Action time:	≤25ms	
释放时间 Release time:	≤25ms	
冲击 (稳定性) Shock (stability)	98m/s ²	
振动 Vibration	10Hz to 55Hz, 1.5mm双振幅 10Hz to 55Hz, 1.5mm double amplitude	
湿度范围 Humidity range	5% - 85%RH	
温度范围 Temperature range	-40℃ - 85℃	
引出端形式 Lead out form	快连接式 Quick connect	
重量 Weight	约75g About 75g	
封装方式 Packaging method	防尘罩型 Dust cover type	